











CAR PARK NUMBERS
NET INCREASE:
2 REGULAR CAR PARKS

- 1 EXTEND KERB TO IMPROVE PEDESTRIAN CONNECTIVITY
- 2 NEW RAISED PEDESTRIAN CROSSING BETWEEN SHOPS AND SQUARE
- 3 EXISTING LOCAL BUS STOP & SHELTER TO BE RETAINED
- 4 TAXI RANK RELOCATED
- 5 2 No. BICYCLE HOOPS TO REMAIN
- 6 NEW PATH CONNECTION TO PLAYGROUND
- 7 RELOCATED ACCESSIBLE CAR PARKING SPACE
- 8 REALIGN EXISTING KERB TO CREATE 45 DEGREE ANGLED CAR PARKING
- 9 15 MINUTE SHORT-TERM PARKING BAY
- 10 MAINTAIN 1/2 HOUR PARKING RESTRICTION TO WEST SIDE OF STREET
- 11 MAINTAIN 1 HOUR PARKING RESTRICTION TO PARK SIDE OF STREET

- LEGEND**
-  EXISTING KERB
 -  EXISTING BUILDING
 -  ALTERED CAR OR TAXI PARKING
 -  NEW CAR PARKING SPACES
 -  NEW KERB AND FOOTPATH
 -  NEW RAISED PEDESTRIAN CROSSING
 -  RELOCATED TAXI RANK
 -  NEW PUBLIC TOILETS

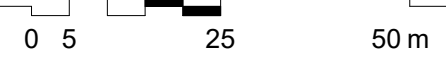
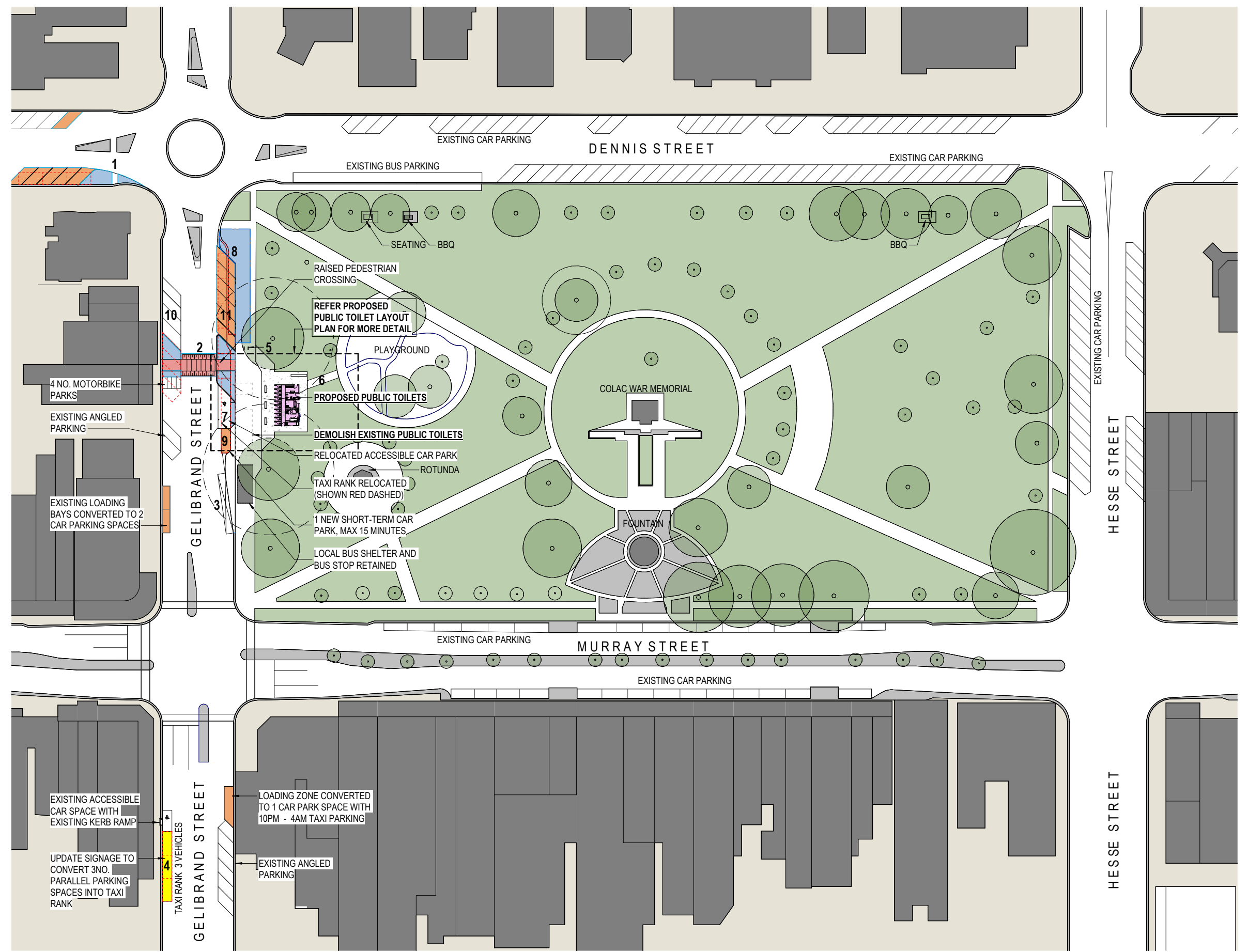

SCALE: 1 : 500@A1
 DATE: 14/07/2021

